



H.U.T HORSE UTILITY TRAILER

Bumper pulls with living quarters? Look no further than Lakota's HUT. Our HUT featuring the Sleep Ez™ tip out design or the round nose HUT with large dinette booth easily assembling into a bed we have a place for you to relax and rejuvenate after a long day on the trails or in the arena.



H211



H211



H211

Our living quarters are designed to provide you with all the comforts of home while the strength and durability of our aluminum frame will provide you with peace of mind.

HUT - The First Horse Utility Trailer



H829LQ



H829LQ

Living Quarter Standards

All HUT Models

- 6-sided fiberglass insulation
- 7,000 BTU Heat strip furnace in A/C
- 12 volt battery
- 55 amp power converter

Standard HUT Model

- SLEEP EZ™ tip-out sidewall expansion
- 3-way folding sofa that sleeps two adults
- Portable folding leg table

Round Nose HUT Model

- Dinette booth with collapsible dinette table
- Additional overhead storage cabinets

Kitchen Standards

- Solid wood oak cabinet doors
- Nickel hardware
- Laminate countertops w/ oak edging
- Stainless steel sink
- Chrome faucet
- 3 cu. ft. Black refrigerator w/space ice box
- Two burner range, cover & hood

Bathroom Standards

- White toilet
- Bronze shower head
- Neo angle walk-in shower with glass enclosure (13' & larger)
- Power vent
- Pocket door
- Neo round walk-in shower with glass enclosure

Popular Living Options

- Soft touch walls & ceilings
- Microwave
- Stainless kitchen appliances
- Skylight over shower
- Comfort air fan in bathroom
- 3.5 Onan generator w/hour meter & transfer switch
- Furnace

Horse Area Standards

- 2 Horse slant load
- Two interior tie downs per horse
- 48" Rubber lining on horse area walls & doors
- Rubber floor mat
- Removable, collapsible rear tack including: bridle hangers, one blanket bar, brush tray, light
- Drop-down feed windows w/ bars (one per horse)
- Padded dividers w/ slam latches
- Lined & insulated walls & ceiling
- Recessed lights
- Manger (8' wide only)
- Padded butt straps
- Pass-through door to living quarters
- Popup roof vent (one per horse)

Popular Horse Area Options

- Feed bag
- Bottom stall divider

6'9" Wide HUT

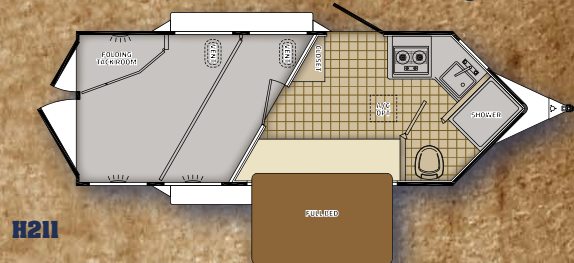

H211

6'9" Wide HUT

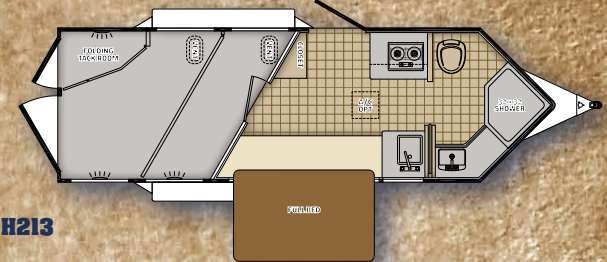

H213

8' Wide HUT

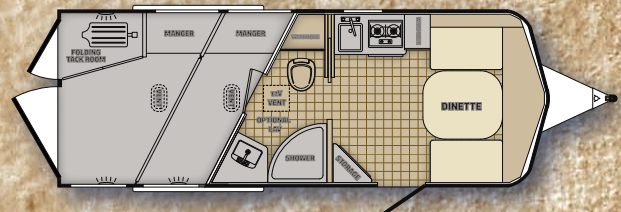

H829LQ

8' Wide HUT

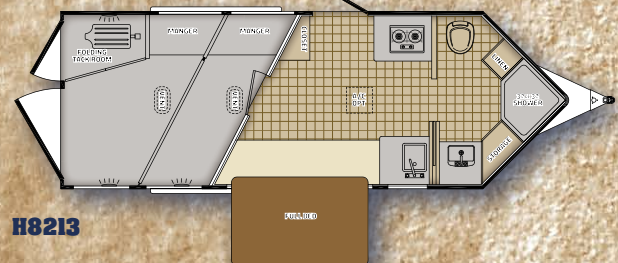

H8213

8' Wide HUT

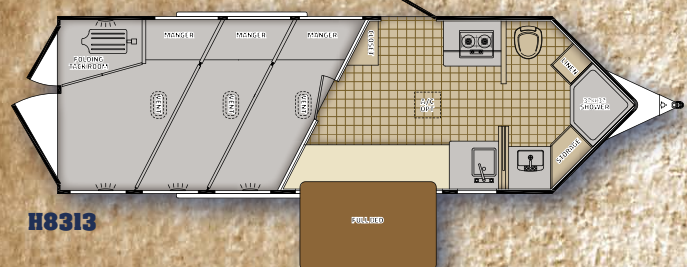

H8313

Your local authorized LAKOTA dealer:



PO Box 219 • 4 Stoutco Drive •
Bristol, IN 46507
574-848-1636 • f. 574-848-1467
info@lakotatrailers.com

Rev 2/11



DISCLAIMER The product information contained herein is believed to be accurate at the time of posting. However, during the model year, it may be necessary to make revisions. Lakota, Inc., reserves the right, at any time, and without prior notification, to make all such changes, including changes in prices, colors, materials, equipment and specifications, as well as the addition of new features and the discontinuance of existing features. Selected decorator items used in photographs are not part of the product. Therefore, please consult with your Lakota, Inc., dealer to confirm the existence of any materials, design or specifications that are material to your purchase decision. Lakota, Inc., assumes no responsibility for any error in type, print, or reproduction of specifications, designs and specifications of outside suppliers, or colors utilized in printing.