



For more information, use
your smartphone's QR
reader to find out more
about the Exiss lineup.

1 (877) 553-9477 | 900 E. Trail Blvd. | El Reno, OK 73036 | www.exiss.com | sales@exiss.com

In keeping with its policy of continuous improvement, Exiss reserves the right to make specification changes at any time without notice or obligation. All dimensions listed in this brochure are approximate. Illustrations may include optional equipment.

© 2011 Exiss | Version 11.9



LIVING QUARTERS

7' WIDE SLANT LOAD HORSE TRAILERS



1 (877) 553-9477 // www.exiss.com // sales@exiss.com

 BY UNIVERSAL TRAILER

ENGINEERED FOR YOU



Exiss 7' wide models represent an incredible value, a trailer built for the rigors of the road, with all of the comforts of quality interiors. Larger models come with a 72-inch sleeper sofa and a large bathroom with a vanity. The Exiss horse area is fully insulated and lined with aluminum and has drop-down feed windows on the streetside for ease and maximum airflow. Built with all of the features and amenities that you would expect from an Exiss, these trailers deliver seemingly limitless options, interior layouts and configurations in a high-value package.





TRAILER FEATURES

CONSTRUCTION FEATURES

- Available in 3H and 4H configurations
- 7' inside height - 7' outside width
- All aluminum construction w/ single piece aluminum roof
- Interlocking extruded plank flooring w/ 2" x 4" I-beams
- Rubber torsion axles w/ electric brakes
- Five 16" 6 hole steel wheels w/ 10 ply radial tires
- Single leg landing gear
- .040 white aluminum sheets on nose, sides
- Extruded aluminum slat outside of horse area
- LED brake and running lights
- Walk-thru door from living quarters to horse area
- One outside tie ring per horse
- Camper door w/ 18" x 24" sliding window and screen door
- Fold-up step under camper door
- One 18" x 24" and 19" x 26" (kickout) window on gooseneck
- Spare tire w/ exterior mount

HORSE AREA FEATURES

- Horse area walls lined and insulated w/ white aluminum
- Rubber installed 48" high w/ kick plate behind
- One inside tie ring per horse
- Lifetime rubber floor mat in horse area
- Streetside drop feed windows w/ drop down bars
- Curbside 18" x 24" windows w/ bars and screen
- Slant stall dividers w/ (patented) slam latch
- Side access door w/ 18" x 24" window w/ bars (3H & 4H)
- One pop-up two-way aluminum roof vent per stall
- 45/55 rear doors w/ 18" x 24" window on load door
- Cam locks and locking keyed hasps on rear doors
- One interior light per divider in horse area
- Fold-up rear tack (lined one side) w/ interior light
- Removable saddle rack, halter hooks and brush tray

SPECIFICATIONS

TRAILER LAYOUTS & DIMENSIONS

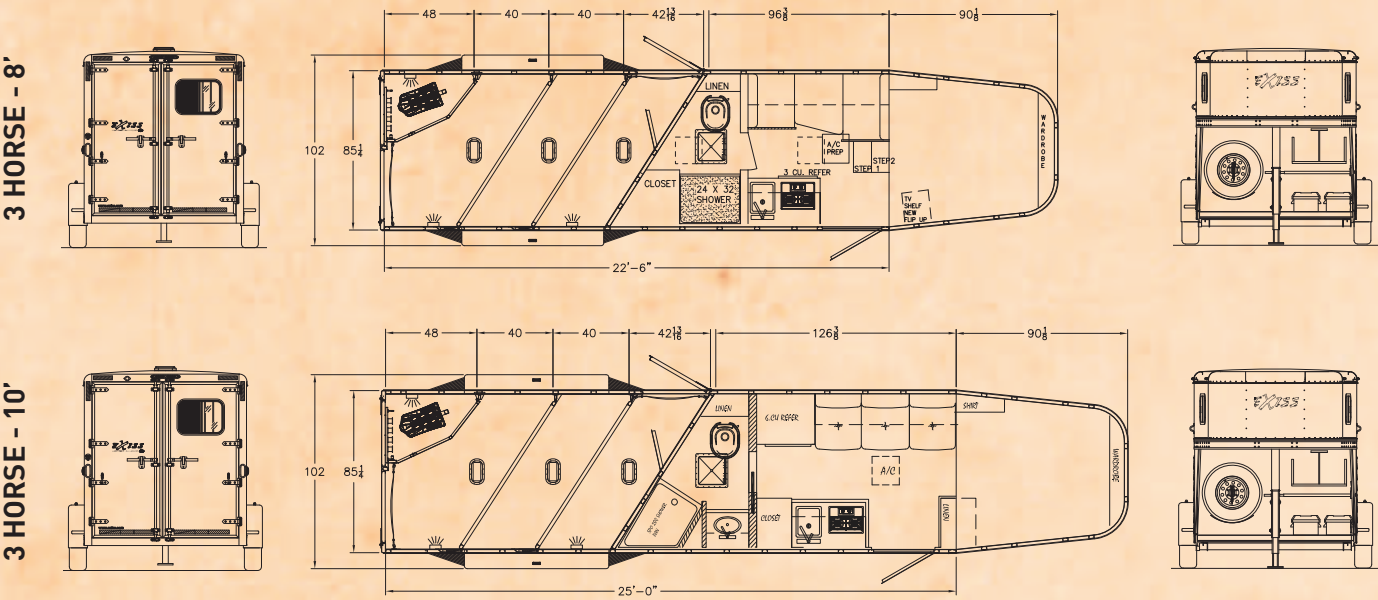

Trailer Model	Belly Length	Interior Height	Outside Width	Interior Length	Horse Stalls	Model Style	GVWR	Empty Weight	Wheel Size	Tire Specs	Axle Size
7308 LQ	22'6"	7'	7'	8'	3	GN	12,000	6,520	16" 6 hole	Radial	(2) 6,000
7408 LQ	26'0"	7'	7'	8'	4	GN	13,500	7,060	16" 6 hole	Radial	(2) 6,000
7310 LQ	25'0"	7'	7'	10'6"	3	GN	12,000	7,120	16" 6 hole	Radial	(2) 6,000
7410 LQ	28'4"	7'	7'	10'6"	4	GN	13,500	7,660	16" 6 hole	Radial	(2) 6,000

POPULAR TRAILER OPTIONS

- Polished exterior slat
- Stainless nose sheet
- Hayrack & Ladder
- Wheel simulators
- Black, red or silver exterior skin
- Curbside drop down feed doors
- Single leg hydraulic jack
- Graphics
- Lower divider panel
- Stall pads
- Insulated roof in horse area
- Full length running boards
- Full width rear ramp
- Halogen load lights
- Additional marker lights

WE STAND BEHIND OUR TRAILERS! To demonstrate our confidence in our trailers, we've increased our warranty coverage! Now, all new 2012 Exiss living quarters trailers come standard with a fully transferrable, eight-year limited warranty.





INTERIOR FEATURES

SIERRA INTERIOR FEATURES

- Available with 8' or 10' shortwall
- Paneled & insulated walls and ceiling
- Double bulb incandescent ceiling lights
- Residential grade linoleum floor
- Lighted grab handle and porch light
- Decorative window surrounds
- Window valances (leather touch)
- Metal blinds on all windows
- Carpeted bedroom w/ TV shelf and hanging shirt closet
- Clothes closet at front of gooseneck
- Laminate counter tops
- Flat panel cabinet doors w/ vinyl wrapped cabinet faces
- 2-way, 3 cubic foot refrigerator (6 cubic foot refrigerator on 10' model)
- Smoke detector, LP sensor and fire extinguisher
- Two burner stove w/ lid
- Lighted vented range hood w/ fan
- Single stainless steel kitchen sink
- Overhead cabinet in kitchen
- Dinette w/ cabinet above
- Hollow core privacy bathroom door
- Stainless steel bathroom sink w/ mirrored medicine cabinet
- Hanging closet w/ clothes rod
- Thetford foot flush toilet
- White shower w/ frosted glass door
- Manual crank bathroom roof vent
- Black western star door pulls
- Chrome colored towel fixtures
- Black, gray and fresh water tank
- 12 volt pressure water system
- Systems monitor (black/gray/fresh)
- 6 gallon manual light water heater
- 16,000 BTU ducted furnace
- Non powered crank-up vent at A/C
- RV/Marine battery in plastic box
- Dual LP tanks w/ regulator
- 110 volt exterior receptacle
- 110 volt to 12 volt 55 amp converter
- 25 ft removable marine shore cord



SPECIFICATIONS



KEY FEATURES

- 1 Carpeted bunk area with TV shelf, (optional) twin mattress, storage cabinets and reading lights
- 2 Fold-out, faux leather sofa / bed with matching portable kitchen table (optional item in lieu of dinette)
- 3 Two burner stove with lid and lighted vented range hood above
- 4 Stand-alone toilet in bathroom (with privacy door and separate shower)
- 5 Bathroom sink and vanity area with mirrored door and storage behind (sink is standard in 10' models only)
- 6 Stainless steel kitchen sink
- 7 3 cu. ft. refrigerator standard (6 cu ft refrigerator in 10' models)
- 8 13,500 BTU air conditioner (optional)



Base Model	Shortwall	Fridge Size	Shower Size	Bathroom Sink	Seating Area Dimensions	Linen Closet	Hanging Closet	Entry Door Layout	A/C Unit Size	Ducted Furnace
7308 & 7408	8'	3 cu.	24" x 32"	N/A	72" sofa	Standard	Standard	Curbside	13,500 BTU	16,000 BTU
7310 & 7410	10'	6 cu.	24" x 32"	Standard	72" sofa	Standard	Standard	Curbside	13,500 BTU	16,000 BTU

BUY YOUR TRAILER WITH CONFIDENCE

When making an investment in a new aluminum trailer, it's nice to know that your trailer is independently certified. You'll be pleased to know that Exiss is a proud member of the **National Association of Trailer Manufacturers** (NATM), and every trailer that Exiss builds meets or exceeds the requirements set forth by the NATM. The interior that we install is built by Sierra Interiors and is indepently certified by **T.R. Arnold**, showing that our interiors adhere to the highest industry standard.



In keeping with its policy of continuous improvement, Exiss reserves the right to make specification changes at any time without notice or obligation. All weights and dimensions listed in this brochure are approximate. Illustrations may include optional equipment.