

LAKOTA CHARGER

GOOSENECKS & BUMPER PULLS



The Solid Choice

RIDE WITH A NEW GENERATION OF HORSE TRAILER

CHARGER

GOOSENECKS & BUMPER PULLS

The Charger is versatile, affordable, proven rugged and lightweight, this trailer will provide years of durability and performance. The Charger is available in a variety of floorplans in both gooseneck and bumper pull with dressing rooms and living quarters.



WWW.LAKOTATRAILERS.COM

60/40 or 50/50 rear door and slat and brite dip options are available.



Charger exteriors are available in white, champagne, or black packages.

Charger is available in traditional or round nose. (round nose shown)



8' wide and 6' 9" wide models are offered in the Charger line.



C8313
Rear Kitchen Bar with
U-Shaped Dinette Option



CHARGER

The C8313, featuring the U-Shaped dinette option, offers more seating and storage space. The TV swings for convenient viewing in the bed or living areas.

WWW.LAKOTA TRAILERS.COM

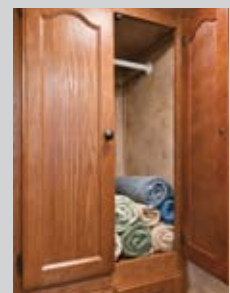



C8313
Neo Angle Shower

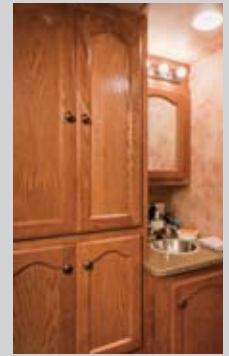

This well designed model offers plenty of storage space for all of your traveling needs.



C39
with Slide Out



The Charger line is packed with affordable comfort all around. The excellently coordinated décor and wood tones create a beautiful looking interior package.

FLOORPLANS

Goosenecks

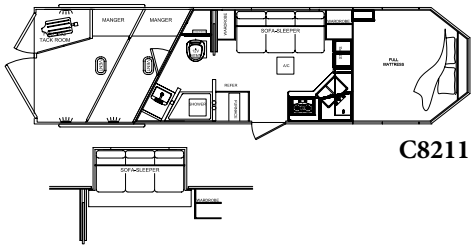

C8211

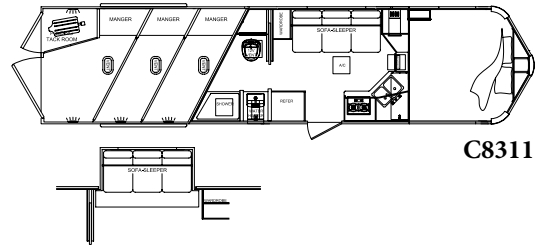

C8311

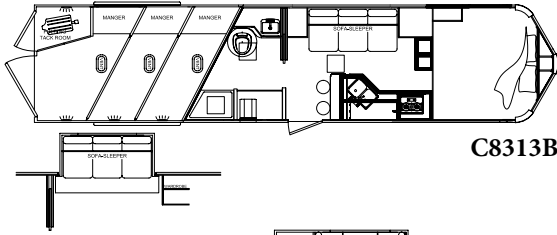

C8313B

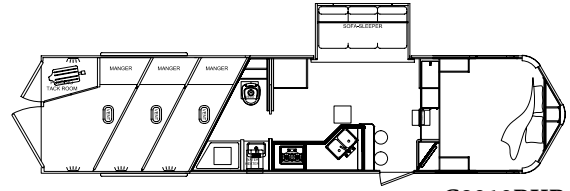

C8313BKB

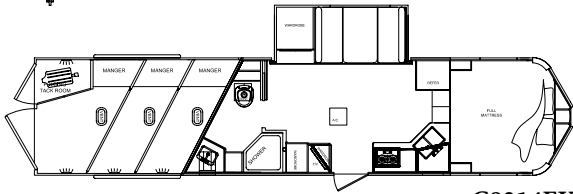

C8314FK

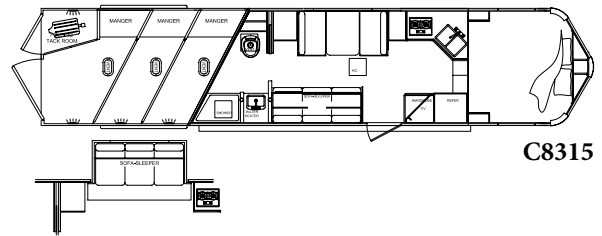

C8315

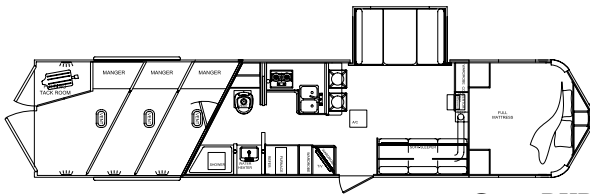

C8315RKB

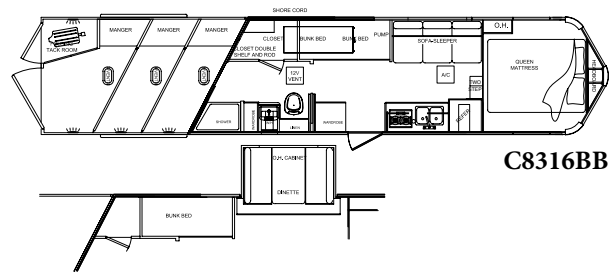

C8316BB

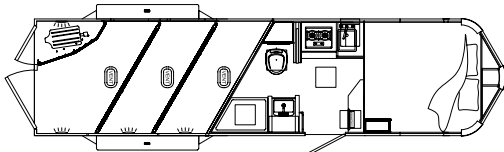

C35

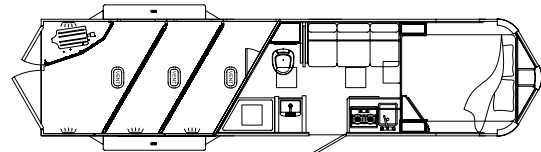

C37

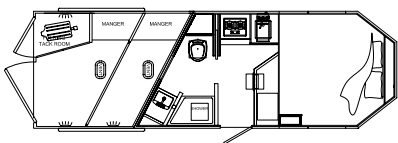

C825

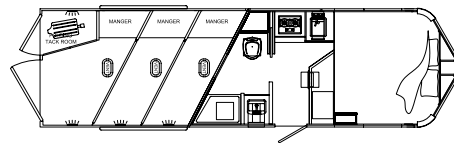

C835

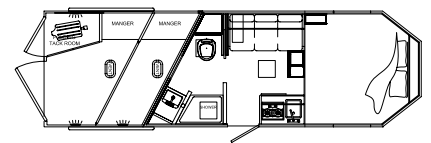

C827

All specifications contained herein are based on the latest product information at time of printing. Lakota reserves the right to make changes in colors, materials, equipment and specifications at any time without notice and assumes no responsibility for any errors in this brochure.

WWW.LAKOTA TRAILERS.COM

Bumper Pulls

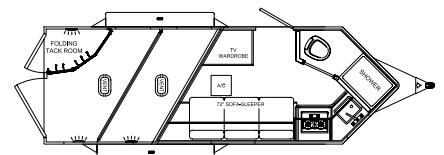

C211BPSE

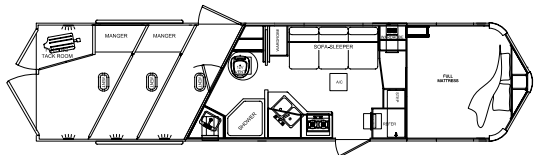

C8311RK

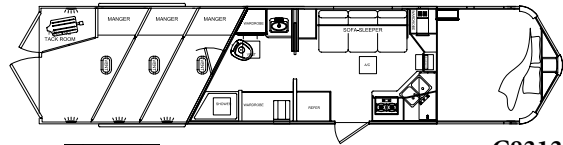
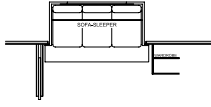

C8313

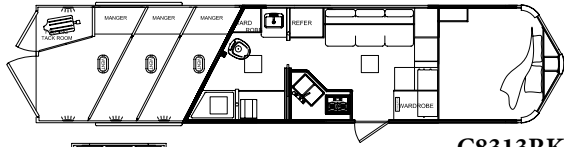

C8313RK

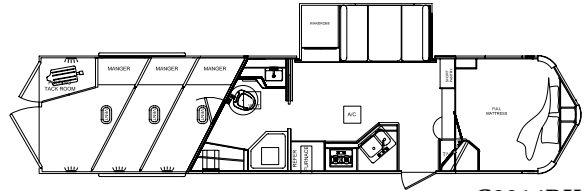

C8314RK

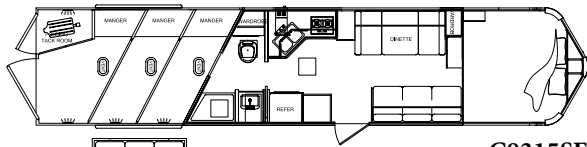

C8315SE

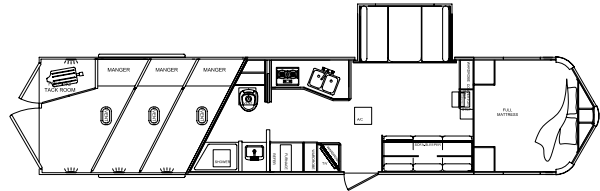
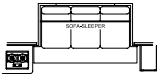

C8315RK

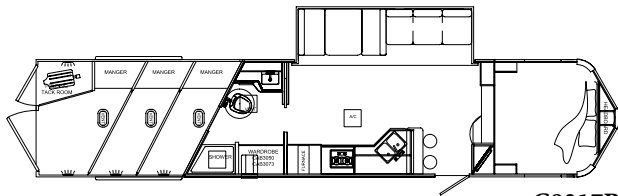

C8317B

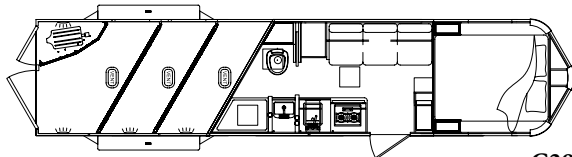

C39

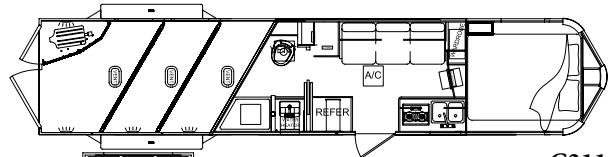
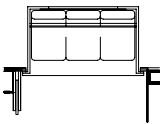

C311

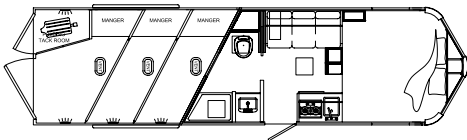
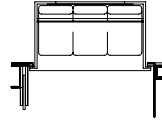

C837

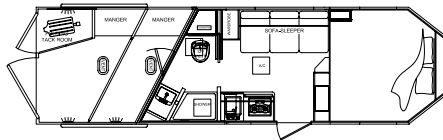

C829

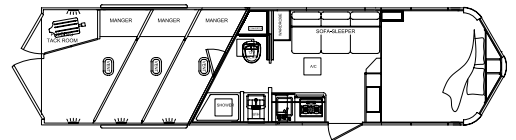
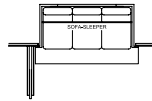

C839

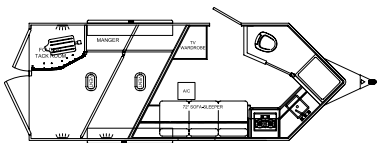
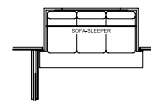

C8211BPSE

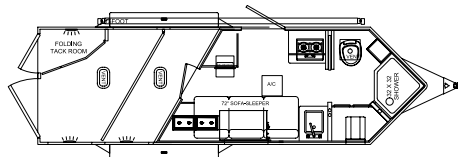

C213BPSE

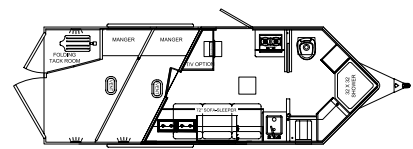

C8213BPSE

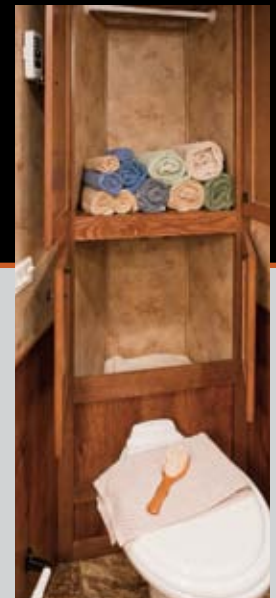

C8315
Rear Kitchen Bar

The plush living area offers plenty of room to relax after a long day of trail riding. This spacious bathroom includes lots of storage space.

Horse Trailer Standards

- 8' wide & 6' 9" wide
- All-aluminum framing
- Insulated aluminum walls & ceiling in horse area
- Rubber stall matting
- 48" wall lining kick plate
- Aluminum padded stall dividers with slam latches
- Two-way pop up vents (one per horse)
- Butt windows
- Recessed lights in horse area
- 60/40 rear doors (slant load)
- Ramp with Dutch doors (straight load)
- Seamless aluminum roof with drip rail
- LED exterior lights
- Radial tires
- Saddle tree
- Load light
- Recessed rear light switches
- Gate springs
- Square drop down feed doors

Other Popular Options

- Extruded slat exterior
- Stainless steel wheel covers
- All-aluminum floor (STD LQ units)
- Folding, collapsible rear tack (STD LQ units)

- Rear ramp (slant load only)
- Electric jack (Bumper Pull)
- Electric/hydraulic jack (6' 9" wide only)
- 2nd electric/hydraulic jack (8' wide only)

Gooseneck Living Quarter Standards

- R8 spun fiberglass insulation
- ¾" tongue & groove plywood floor
- Wood grain linoleum floors
- Solid hardwood, flat panel oak cabinets
- Satin nickel hardware
- Stainless kitchen sink
- Jack knife sofa (VBP)
- 24" angle shower
- Black appliances
- 3 burner range with hood
- 16,000 BTU furnace, 13,500 A/C
- 6 gallon gas water heater
- Fresh water tank, sizes vary by model
- 33 gallon each grey and black water tanks
- Night shades
- Water tank drain valve
- Bath lavatory
- Valances
- Mattress & bedspread
- Wainscoating
- Sconce lighting
- Puck lighting in ceiling

Other Popular Options

- 72" slide out
- INTERIOR PACKAGE INCLUDES:** Pass thru door, skylight in bathroom, dual batteries, and rain sensor fan

- ENTERTAINMENT PACKAGE INCLUDES:** TV, DVD/CD/AM/FM player, 2 interior speakers, and 2 exterior speakers

- EXTERIOR PACKAGE INCLUDES:** Spare tire, outside water spigot, awning, and additional load light

- HORSE AREA PACKAGE INCLUDES:** RS escape door, bottom stall divider, and saddle boss IPO standard



Our 5 + 2 + 1 Warranty has you covered. It guarantees the aluminum structure for 5 years, the living quarters for 2 years, hitch to bumper and workmanship for 1 year.

PO Box 219 • 4 Stoutco Drive
Bristol, IN 46507
info@lakotatrailers.com
574.848.1636

Your Local Authorized Lakota Dealer:

WWW.LAKOTA TRAILERS.COM